



SPEED QUEEN® QUANTUM® TOUCH
Tumble Dryers

STT30
2x30 lb (14 kg)

STT45
2x45 lb (20 kg)

STO30
30 lb (14 kg)

STO55
55 lb (25 kg)

STO75
75 lb (34 kg)

Quantum® Touch Control

Reimagine your laundry experience with the Speed Queen Quantum Touch display. Clear, easy to use, easy to understand directions with profitable cycle modifiers enhance your customers' experience and increase return on investment.

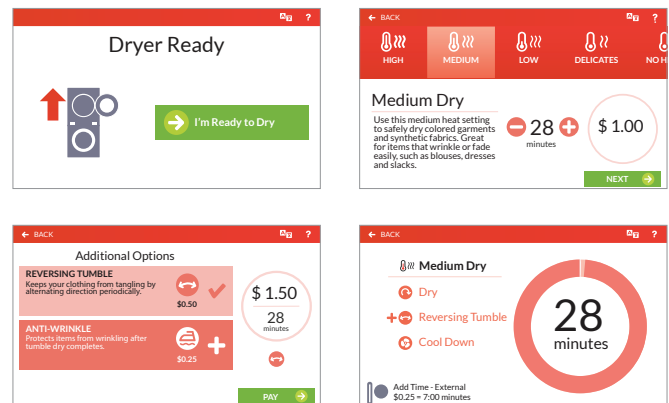

- User-friendly screen with operating instructions built in as part of the control
- 5 basic cycles (high, medium, low, delicate, no heat)
- Easy-to-understand cycle modifier prompts will encourage your customers to customize their dry
- Flexible pricing & additional revenue opportunities with customizable cycle modifiers, time-of-day pricing and lucky cycle options
- 30+ languages available
- On screen timer so your customers know exactly how much time their cycle will take
- Flexible Payment Options - Coin, Card, Mobile, Cash

SPEED QUEEN® QUANTUM® TOUCH

Tumble Dryers

Our tumble dryers are built with a single purpose: performance. They are specifically designed with fewer moving parts, so you'll face fewer maintenance issues over their lifespan.

- 5", full color, touch screen display on stack tumble dryers (7" display on single tumble dryers)
- Chrome door ring
- Lint trap blends in with front panel for a sleek, modern look
- Innovative galvanized cylinder design with stainless steel back
- Patented oval cylinder perforations prevent small metal objects from passing through and damaging the dryer's sweep sheets
- Axial Airflow provides the most concentrated and efficient drying possible to make dry times even faster, while saving you money

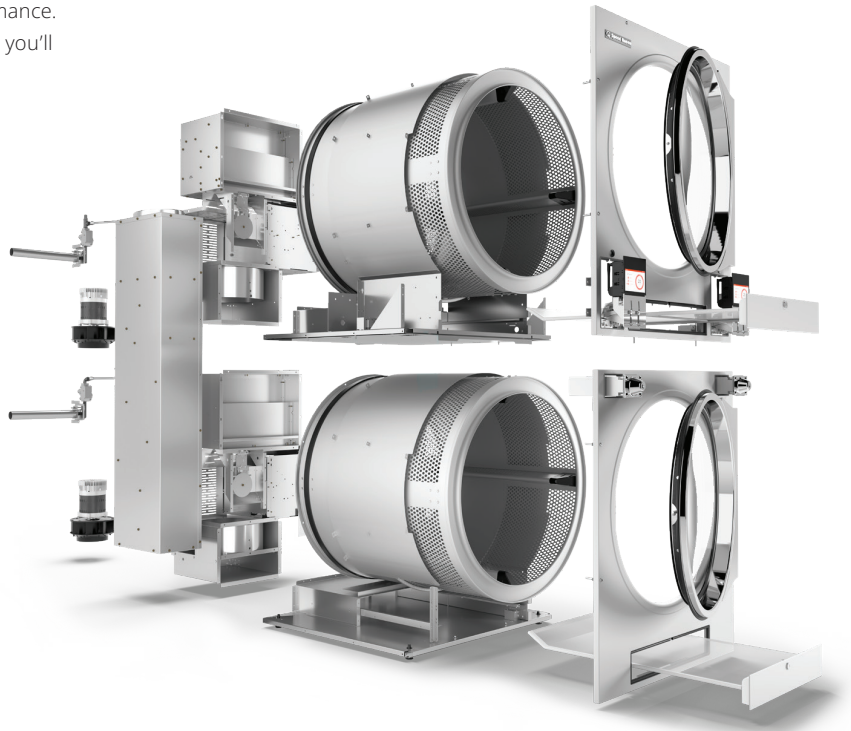

SPEED QUEEN®
INSIGHTS
READY

Take your business to new levels of efficiency and profitability with advanced analytics and customer data—all integrated into the same platform with the rest of your business management tools. Know how often each customer visits, which machines they use, how they pay, and use that information to increase your revenue through stronger customer relationships and a more rewarding laundry experience.

SPEED QUEEN® QUANTUM® TOUCH

Single Tumble Dryers

		ST030	ST055	
Control Option		Quantum Touch	Quantum Touch	
Capacity - lb (kg)		30 (14)	55 (25)	
Overall Width - in (mm)		27.9 (709)	34.5 (876)	
Overall Depth - in (mm)		45.5 (1156)	53.1 (1349)	
Overall Height - in (mm)		63.9 (1623)	66.7 (1694)	
Cylinder Diameter - in (mm)		26.5 (673)	33 (838)	
Cylinder Depth - in (mm)		30.0 (762)	35.0 (889)	
Cylinder Volume - cu. ft (liters)		9.6 (272)	17.3 (490)	
Reversing Cylinder		Option	Option	
Door Opening Size - in (mm)		22.7 (577)	26.9 (683)	
Heat Input Power	Gas Models - Per Pocket	73,000 Btu/hr	112,000 Btu/hr	
	Steam Models - Per Pocket	83,500 Btu/hr	-	
	Electric Models	21kW	27kW	
Gas Connections - in (npt)		0.5	0.5	
Plumbing Connections - Steam - in (npt)		0.75	-	
Air Outlet - in (mm)		6 (152)	8 (200)	
Motor - HP	Fan	0.3	0.5	
	Cylinder	0.3	0.5	
Airflow - cfm		500	700	
Electrical Specs - amps	Gas & Steam			
	B	100-120V/50/60/1	10	12
	X	200-240V/50/60/1/3	6	7
	N	440-480V/50/60/3	3	3
	P	380-415V/50/60/3	3	3
	Electric			
	D	200-208V/50/60/1	104	133
	E	230-240V/50/60/1	90	116
	F	200-208V/50/60/3	61	78
	G	230-240V/50/60/3	52	67
	H	380V/50/60/3	33	42
	J	400-415V/50/60/3	30	39
	K	440V/50/60/3	29	37
	L	460-480V/50/60/3	27	34
Shipping Dimensions Approx.- in (mm)	Width	30.0 (762)	35.5 (902)	
	Depth	49.0 (1245)	57 (1448)	
	Height	67.6 (1717)	70.5 (1791)	
Net Weight - lb (kg)	Gas & Steam	320 (145)	430 (195)	
	Electric	330 (150)	440 (200)	
Shipping Weight - lb (kg)	Gas & Steam	340 (154)	470 (213)	
	Electric	350 (159)	480 (218)	
Agency Approvals		CSA	CSA	

Single & Stack Tumble Dryers

		ST075	STT30	STT45	
Control Option		Quantum Touch	Quantum Touch	Quantum Touch	
Capacity - lb (kg)		75 (34)	30 (14) x 2	45 (20) x 2	
Overall Width - in (mm)		38.5 (978)	31.5 (800)	34.5 (875)	
Overall Depth - in (mm)		53.0 (1346)	42.8 (1087)	48.6 (1235)	
Overall Height - in (mm)		77.3 (1963)	76.3 (1938)	81.3 (2065)	
Cylinder Diameter - in (mm)		37.0 (940)	30.0 (762)	33.0 (838)	
Cylinder Depth - in (mm)		36.0 (914)	26.0 (660)	30.0 (762)	
Cylinder Volume - cu. ft (liters)		22.4 (634)	10.6 (300)	14.8 (419)	
Reversing Cylinder		-	Option	Option	
Door Opening Size - in (mm)		26.9 (683)	22.6 (574)	26.9 (683)	
Heat Input Power	Gas Models - Per Pocket	150,000 Btu/hr	73,000 x 2 Btu/hr	95,000 x 2 Btu/hr	
	Steam - Per Pocket	133,900 Btu/hr	85,400 x 2 Btu/hr	-	
	Electric Models	36kW	21 x 2 kW	-	
Gas Connections - in (npt)		0.5	0.5	0.5	
Plumbing Connections - Steam - in (npt)		0.75	0.75	-	
Air Outlet - in (mm)		8 (200)	1 x 8 (200) oval	1 x 10 (250) oval	
Motor - HP	Fan	0.5	0.3	0.5	
	Cylinder	0.5	0.3	0.5	
Airflow - cfm		800	2 x 400	2 x 600	
Electrical Specs - amps	Gas & Steam				
	B	100-120V/50/60/1	12	16	20
	X	200-240V/50/60/1/3	7	9	12
	N	440-480V/50/60/3	3	6	6
	P	380-415V/50/60/3	3	6	6
	Electric				
	E	230-240V/50/60/1	-	-	-
	F	200-208V/50/60/3	104	61 x 2	-
	G	230-240V/50/60/3	90	52 x 2	-
	H	380V/50/60/3	56	33 x 2	-
	J	400-415V/50/60/3	52	30 x 2	-
	K	440V/50/60/3	49	29 x 2	-
	L	460-480V/50/60/3	45	27 x 2	-
Shipping Dimensions Approx. - in (mm)	Width	41.5 (1054)	32.5 (826)	35.5 (902)	
	Depth	56.0 (1422)	47.0 (1194)	54.0 (1372)	
	Height	Gas & Electric - 81.0 (2057) Steam - 83.5 (2121)	79.9 (2029)	84.9 (2156)	
Net Weight - lb (kg)	Gas	690 (313)	570 (259)	710 (322)	
	Steam	710 (322)	610 (277)	-	
	Electric	720 (327)	660 (299)	-	
Shipping Weight - lb (kg)	Gas	740 (336)	600 (272)	750 (340)	
	Steam	760 (345)	640 (290)	-	
	Electric	770 (349)	690 (313)	-	
Agency Approvals		CSA	CSA	CSA	

Single & Stack Tumble Dryers

		ST075	STT30	STT45
Packed (with crate) Dimensions Approx.- in (mm)	Width	46.0 (1170)	35.5 (900)	40.0 (1020)
	Depth	59.0 (1500)	50.0 (1270)	60.0 (1520)
	Height	88.3 (2240)	87.0 (2210)	87.0 (2210)
Gross weight (with crate) - lb (kg)	Gas	870 (395)	730 (330)	930 (420)
	Steam	910 (415)	770 (350)	-
	Electric	900 (410)	790 (360)	-

Tumble dryer models are made to suit a variety of electrical service characteristics. See your Speed Queen distributor for specifications. For further details on installation, refer to Installation, Operation and Maintenance instructions supplied with the tumble dryer. Amperage ratings available in Installation Manual. For the most accurate information, the installation guide should be used for all design and construction purposes. Due to continuous product improvements, design and specifications subject to change without notice. The quality management systems of Alliance Laundry Systems are registered to ISO 9001.

Single & Stack Tumble Dryers

Dimensions - in (mm)	ST030	ST055	ST075	STT30	STT45
A	26.3 (670)	31.9 (810)	29.2 (740)	28.0 (710)	31.9 (810)
B	27.5 (700)	26.9 (680)	33.9 (860)	49.0 (1.245)	50.4 (1.280)
C	28.4 (720)	33.4 (850)	53.0 (1350)	48.3 (1.225)	49.3 (1.250)
D	31.8 (810)	36.8 (935)	77.3 (1960)	11.4 (290)	10.3 (260)
E	45.5 (1155)	53.1 (1350)	42.2 (1070)	10.7 (270)	9.3 (235)
F	63.9 (1625)	66.7 (1700)	38.5 (980)	25.0 (635)	29.0 (735)
G	16.5 (420)	17.75 (450)	33.0 (840)	28.7 (730)	32.7 (830)
H	15.4 (390)	18.7 (475)	7.7 (200)	42.8 (1.090)	48.6 (1.235)
I	1.6 (40)	1.6 (40)	6.2 (160)	27.4 (695)	30.4 (770)
J	24.6 (625)	30.5 (775)	13.8 (350)	31.5 (800)	34.5 (875)
K	27.9 (710)	34.5 (876)	35.5 (900)	76.3 (1.940)	81.3 (2.065)
L	-	-	39.2 (1000)	-	-

ST030, ST055

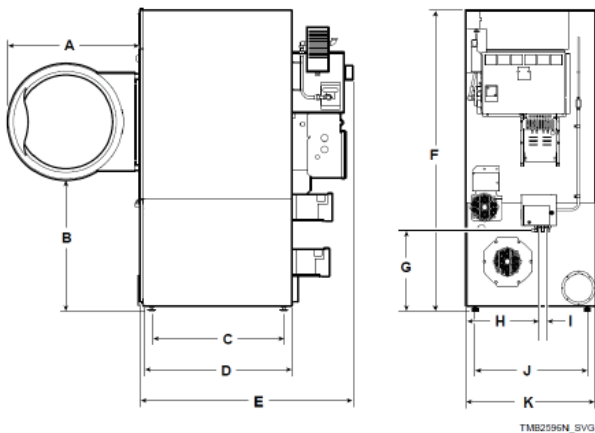

ST075

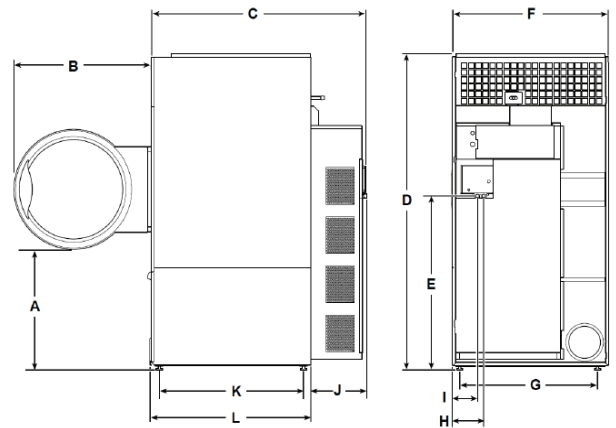

STT30, STT45

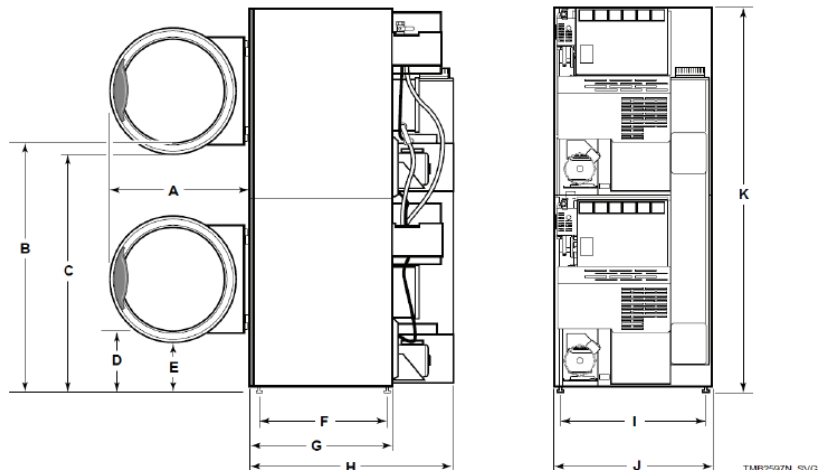

WESTERN AUSTRALIA

7/15 Walters Drive
Osbourne Park WA 6017
T: 08 9445 7744
enquiry@speedqueenwa.com.au

NEW SOUTH WALES & ACT

245 Rawson Street
Auburn NSW 2144
T: 02 9748 2155
enquiry@speedqueenlaundry.com.au

SOUTH AUSTRALIA & NT

385-387 Main North Road
Enfield SA 5085
T: 08 7095 0336
sa@speedqueenlaundry.com.au

QUEENSLAND

2/18 Gravel Pit Road
Darra QLD 4076
T: 07 3376 3869 *Home retail
qld@speedqueenlaundry.com.au